



BEANFIELD CENTRE

GREEN MEETING SPACES WITH LEADING-EDGE TECHNOLOGY

ABOUT

Whether you are hosting 50 or 2,000 delegates, Beanfield Centre has the capacity to ensure your success. From flexible meeting spaces to Toronto's largest ballroom, Beanfield Centre offers fast and free upgraded Wi-Fi 6 to satisfy your delegates' needs. For larger groups, Beanfield Centre is directly connected to Enercare Centre – the largest exhibition and convention centre in Canada. The added convenience of connected underground parking and an adjacent on-site hotel makes Beanfield Centre the ideal location for your next meeting.



150K+

SQ. FT. OF FLEXIBLE CONVENTION SPACE



COMPLIMENTARY UPGRADED WI-FI 6



20

MEETING ROOMS



CENTRALLY LOCATED AND EASILY ACCESSIBLE



LEED® SILVER CERTIFIED



2

BALLROOMS

BUILDINGS SPECIFICATIONS

- ☒ Floor loading of 350 pounds-per-square-foot in ballroom and 50 pounds-per-square-foot in meeting rooms
- ☒ Loading and unloading areas along West side of the Centre with 5 loading docks and 2 ground level roll up doors
- ☒ Ballroom sound system has 400W amps and 28 loudspeakers to provide voice amplifications and audio supplements
- ☒ 5500 ANSI lumen LCD based install grade projector with 600:1 contrast ratio
- ☒ Ballroom floor port electrical power is available 120/208 volt in all floor ports with 600 volt available in specified floor port along the ground in the ballroom

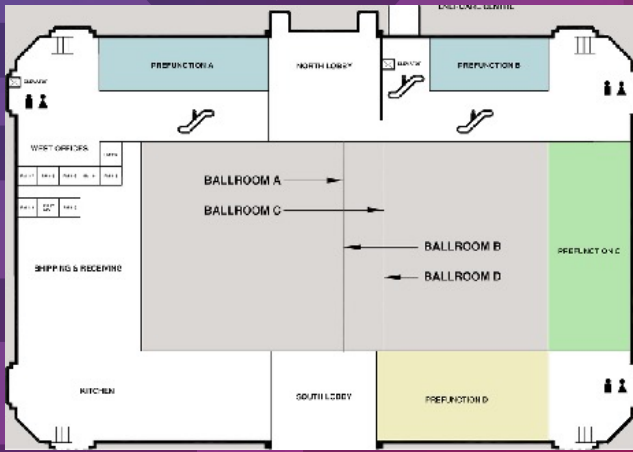

MAIN FLOOR

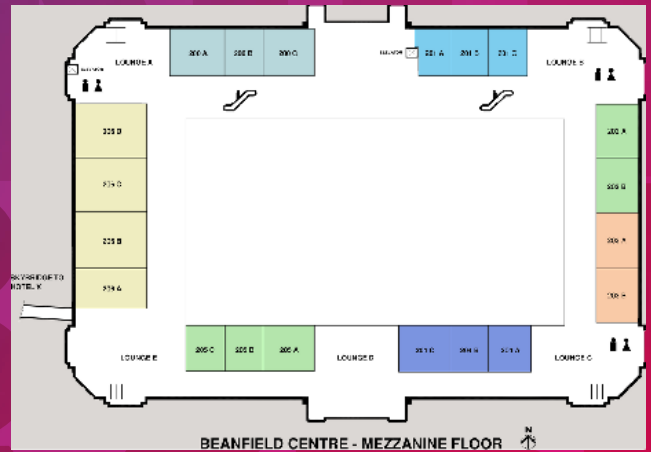

SECOND FLOOR

MAIN FLOOR

ROOM	DIMENSIONS	AREA	THEATRE	CLASSROOM	BANQUET	RECEPTION
BALLROOM A+B	419'3" x 150'6"	44,260	3,900	2,394	2,280	3,750
BALLROOM A	146' x 150'6"	21,973	1,510	1,080	1,070	1,862
BALLROOM B	148'3" x 150'6"	22,311	1,586	1,080	1,070	1,890
BALLROOM C*	175'1" x 150'6"	26,350	2,304	1,368	1,500	2,233
BALLROOM D*	119'2" x 150'6"	17,934	1,500	801	860	1,519
PRE-FUNCTION A	94'7" x 33'8.5"	3,190	N/A	N/A	N/A	824
PRE-FUNCTION B	85'4" x 31'5.75"	2,698	N/A	N/A	N/A	974
PRE-FUNCTION C	155'4" x 58'6"	9,111	1,148	540	350	772
PRE-FUNCTION D	158'1" x 60'1.5"	8,293	650	357	300	702

SECOND FLOOR

ROOM	DIMENSIONS	AREA	THEATRE	CLASSROOM	BANQUET	RECEPTION
200 A+B+C	36'9" x 111'10"	4,108	383	180	280	346
201 A+B+C	36'9" x 86'10"	3,096	293	165	200	261
202 A+B	33'10" x 84'5"	2,863	246	144	160	242
203 A+B	33'10" x 85'8"	2,897	242	144	160	245
204 A+B+C	35'11" x 102'8"	3,686	350	168	260	311
205 A+B+C	35'11" x 99'10"	3,584	350	156	250	302
206 A+B+C+D	55'9" x 160'4"	8,939	874	480	520	809

Meeting rooms include lectern with microphone, riser, one standard room set (classroom and meeting rounds are linen-free), built-in AV, water station, one vacuum, Wi-Fi 6 Internet, and AODA compliant.

All meeting rooms can be booked separately or grouped